

Standard Latrine Rails

Maker Manual

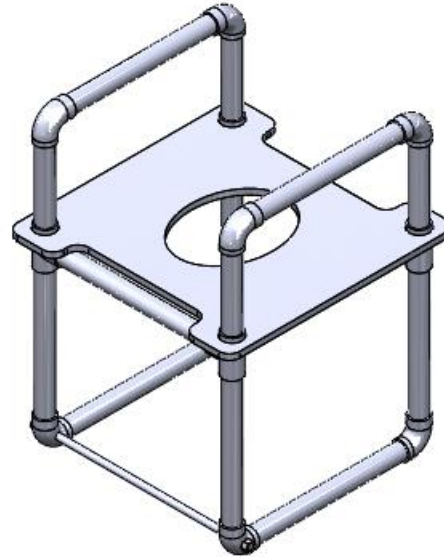

Please use in conjunction with the engineering drawing pack



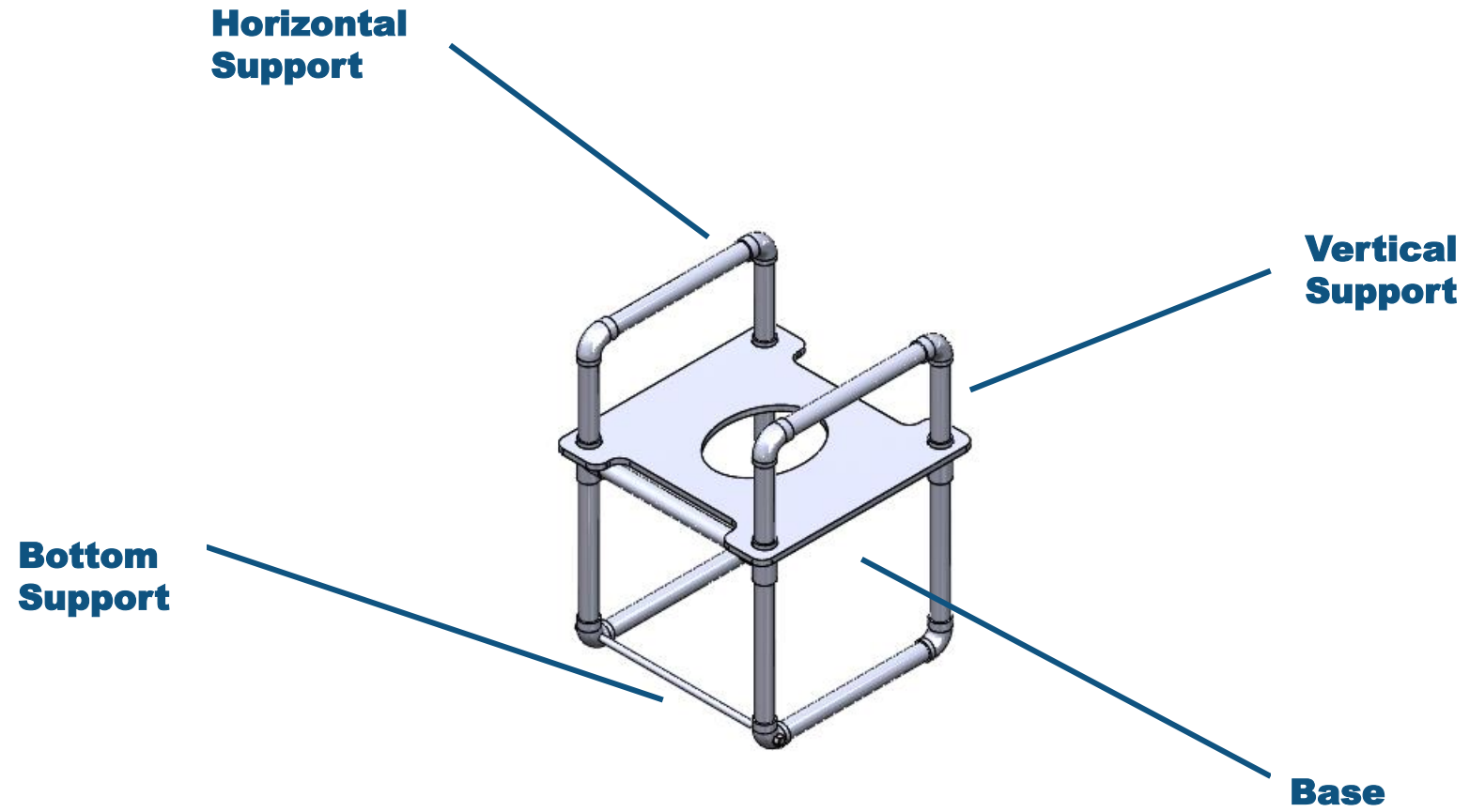

Materials



32mm PVC Pipe

Length
220mm
440mm
380mm

Quantity
5
4
4



32mm PVC Tee Connector x4



12mm PVC Pipe

Length
300mm

Quantity
1



500ml PVC Glue



32mm PVC Elbow Connector x8



640x625 mm exterior Ply (12mm)

Step 1: Material Prep.

1. Cut 32mm and 12mm PVC parts to length.
2. Clean dirt and debris from the pipe.
3. Lightly rub sandpaper on the ends of the pipe for better adhesion when glued.



32mm PVC Pipe

<u>Length</u>	<u>Quantity</u>	<u>Component</u>
440mm	4	a
220mm	4	b
380mm	4	c
220mm	1	d

12mm PVC Pipe

<u>Length</u>	<u>Quantity</u>	<u>Component</u>
300mm	1	e

Step 2.1: Assembly



Apply glue at the mating surfaces of pipe component (a) and two elbows. Connect the three components in the shown configuration.

Step 2.2: Assembly

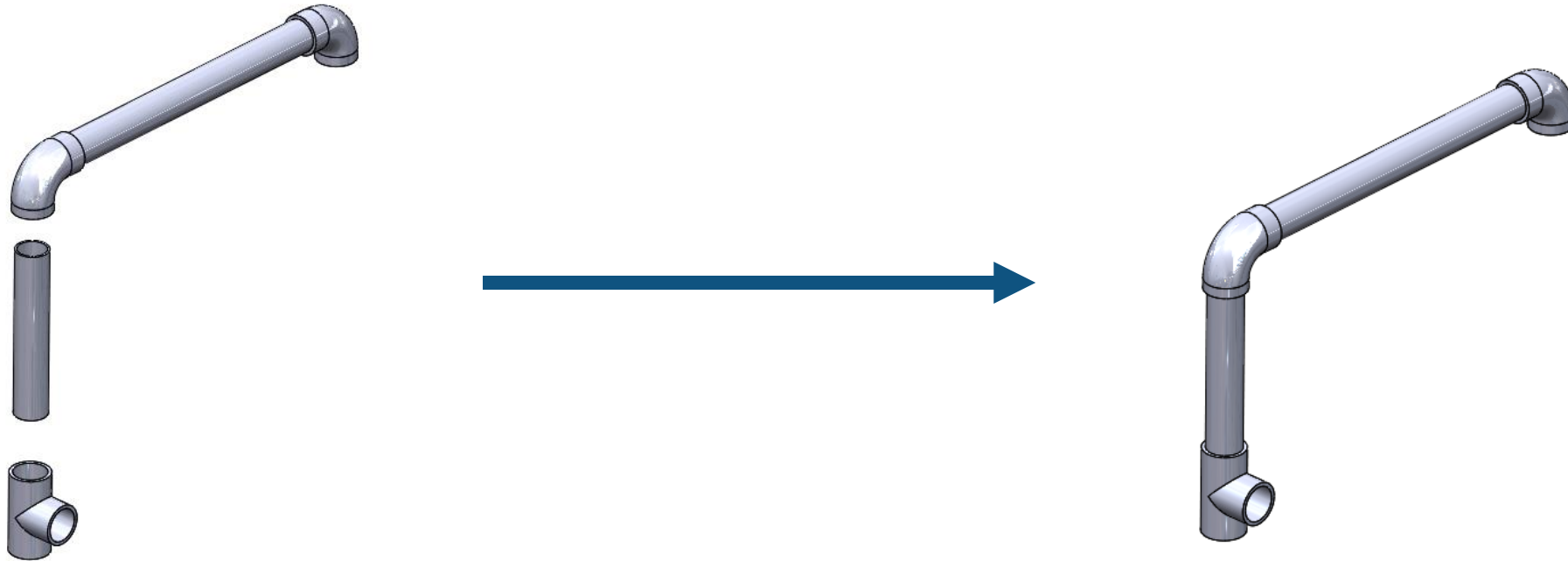

Without Applying glue at the mating surfaces of pipe component (b), one Tee, and the part from Step (2.1). Connect the three components in the shown configuration and in similar way the other side. The glue will be applied when fitting the base.

Step 2.3: Assembly

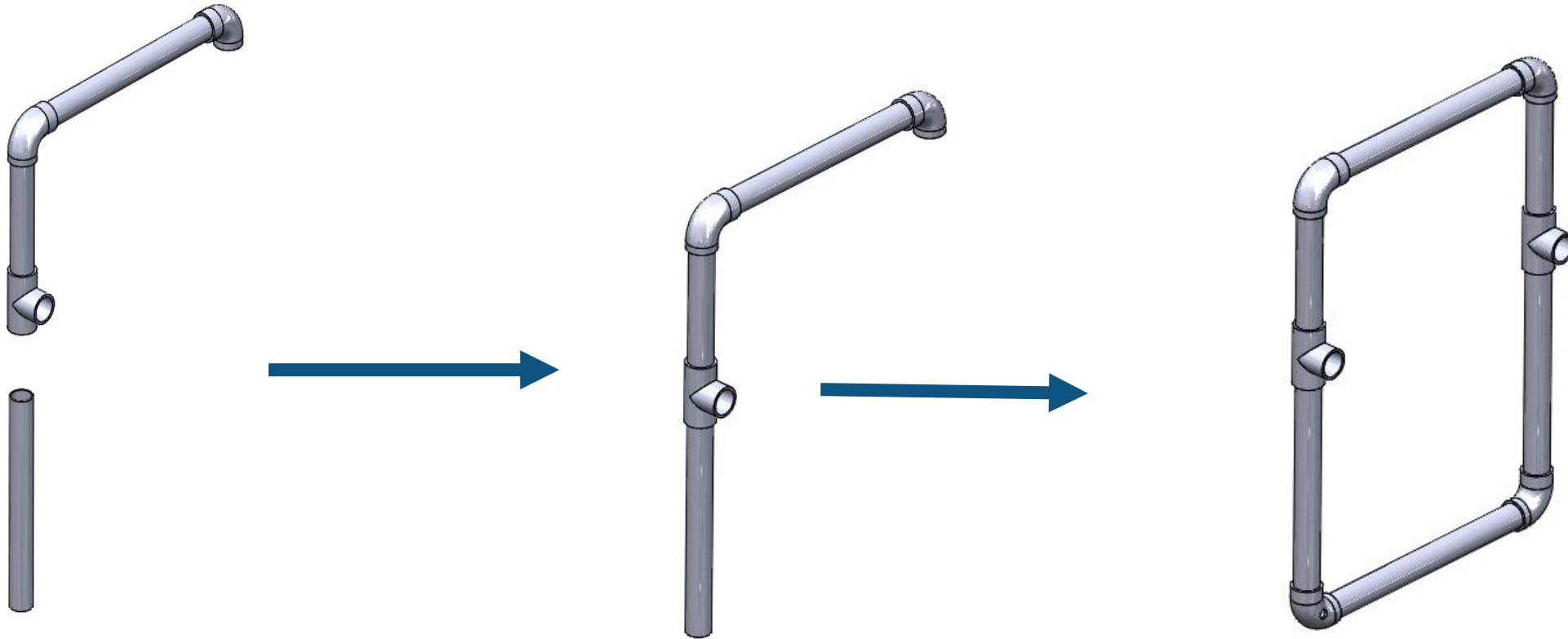

Apply glue at the mating surfaces of one of pipe components (c), and the part from Step (2.2). Connect the three components in the shown configuration. Doing the same all around with components (a), (b) and (c) will complete the side rails.

Step 2.4: Assembly

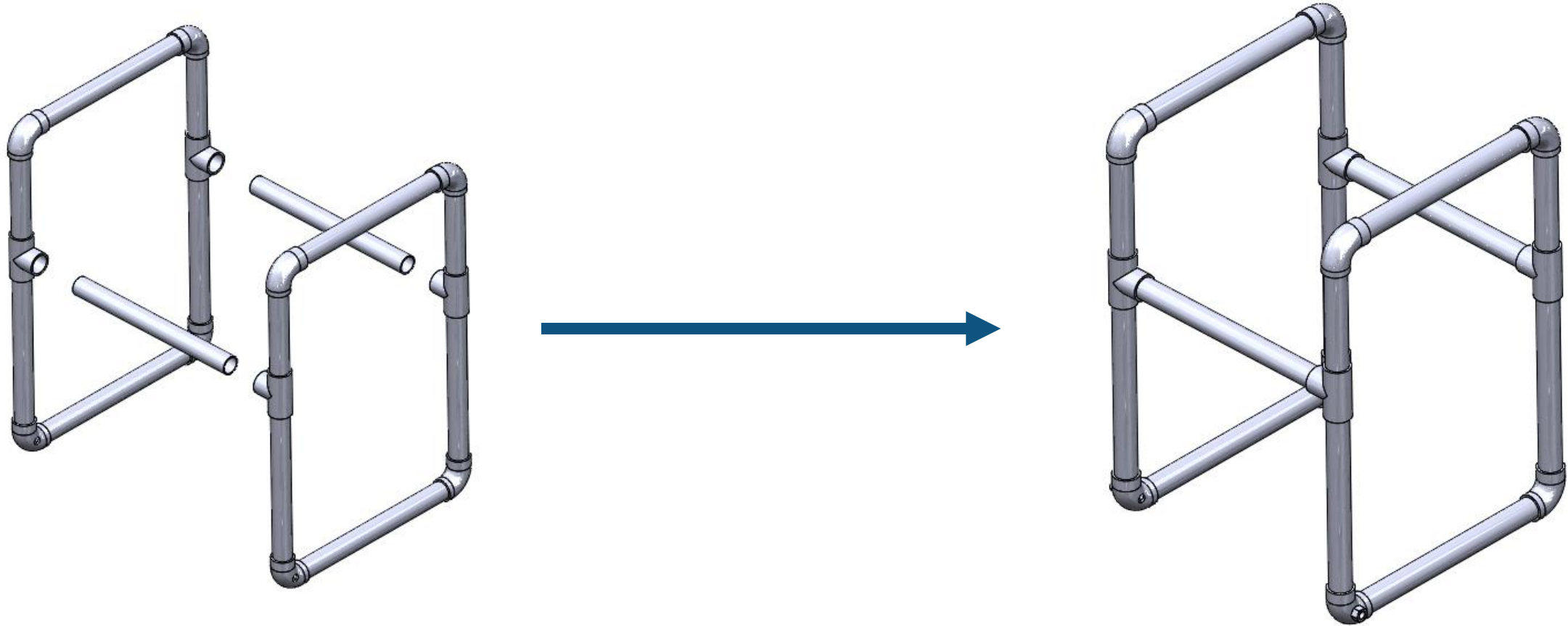

Apply glue at the mating surfaces of pipe component (d), and four tee connectors from the final side rails from step 2.3. Connect the four components in the shown configuration.

Step 2.5: Assembly

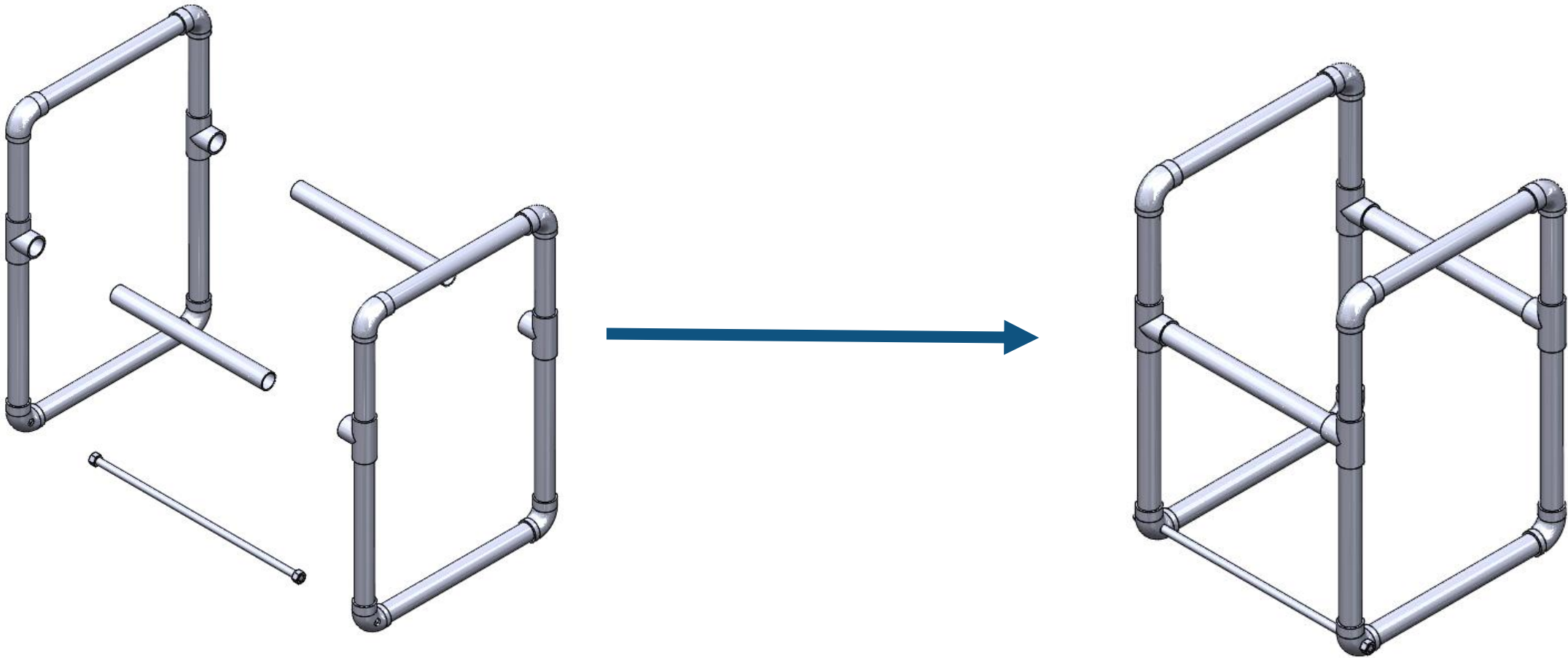

With M16 hex nut and bolt at the mating surfaces of two of the pipe components (e), and the part from step (2.5). Connect the two components in the shown configuration.

Step 2.6: Assembly

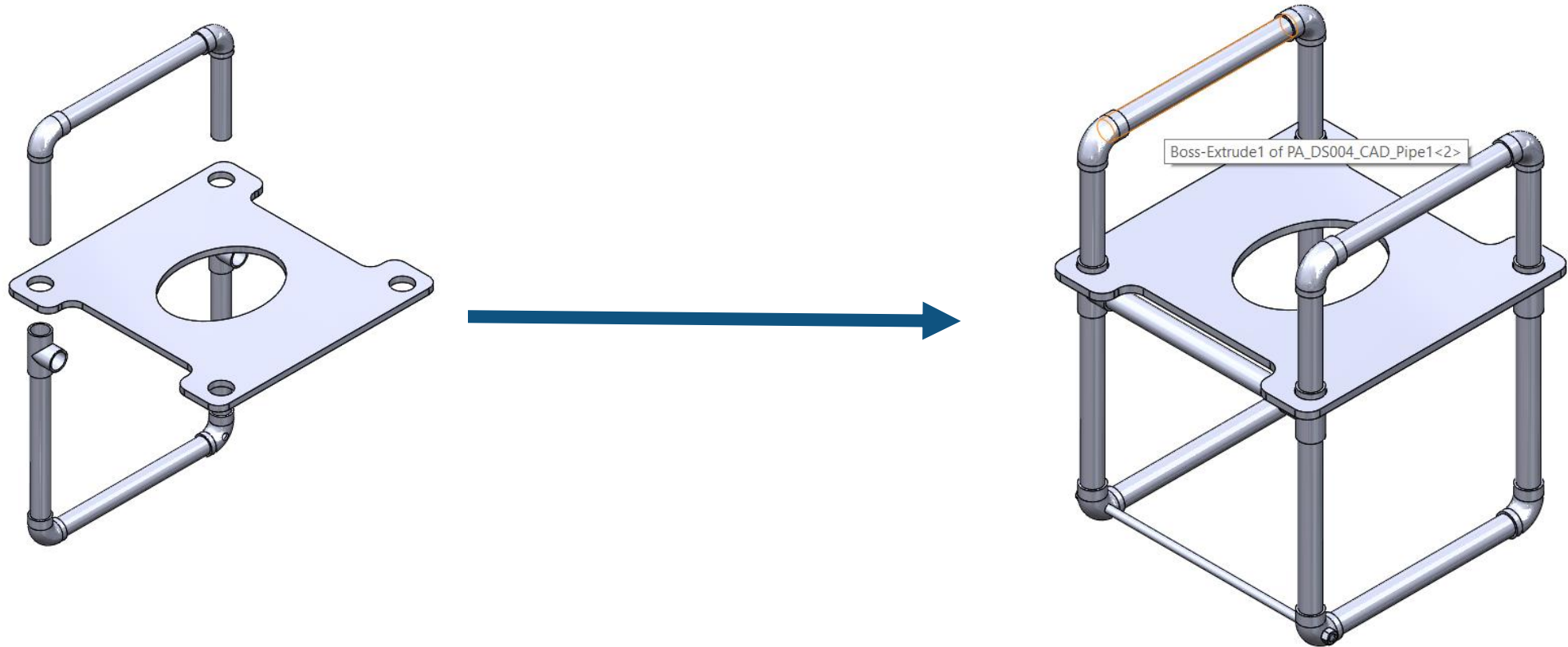

Remove the top part of the rails before the tee which was unglued and insert the plywood base. This should be done on both sides together. After inserting the plywood base, glue the top part of the rail into the tee to get the finished final product.